

KAKUIN

Hakken



MADE IN JAPAN



VICKYtools



SPJ-122

DIAMOND COREDRILL

Power Supply	: 230V 50/60Hz
Rated Current	: 6.5A
Max. Output	: 1,500W
No-Load Speed	: 950 RPM
Size W x L x H	: 180 x 317 x 580mm
Total Weight	: 8.2 Kg



SPN-201

DRILL HEAD

Power Supply	: 230V 50/60Hz
Rated Current	: 8.7A
Max. Output	: 2,400W
No-Load Speed	: 680 RPM
Size W x L x H	: 247 x 328 x 415mm
Weight	: 11.3 Kg

POLE BASE

Stroke	: 505mm
Size	: 177 x 217mm
Height	: 810mm
Weight	: 7.5 Kg
Total Weight	: 18.8 Kg



SPM-300

DRILL HEAD

Power Supply	: 230V 50/60Hz				
Rated Current	: 8.7A				
Max. Output	: 2,400W				
No-Load Speed	<table border="1"> <tr> <td>HI</td> <td>: 880 RPM</td> </tr> <tr> <td>LOW</td> <td>: 370 RPM</td> </tr> </table>	HI	: 880 RPM	LOW	: 370 RPM
HI	: 880 RPM				
LOW	: 370 RPM				
Size W x L x H	: 146 x 179 x 448mm				
Weight	: 10.5 Kg				

POLE BASE

Stroke	: 620mm
Size	: 190 x 255mm
Height	: 1000mm
Weight	: 13.4 Kg

CARRIAGE ASSEMBLY

Weight	: 5.2 Kg
Total Weight	: 29.1 Kg



SPX-16



DRILL HEAD

Power Supply	: 230V 50/60Hz
Rated Current	: 15.8A
Rated Output	: 2,400W
Max. Output	: 6,400W
No-Load Speed-	

HI	: 1,400 RPM
MID	: 800 RPM
LOW	: 300 RPM

Size W x L x H	: 151 x 196 x 496mm
Weight	: 16.1 Kg

POLE BASE

Stroke	: 620mm
Size	: 190 x 255mm
Height	: 1000mm
Weight	: 13.4 Kg

CARRIAGE ASSEMBLY

Reduction Gear Ratio	:
Weight	: 5.2 Kg
Spacer Thickness	: 30mm

Total Weight	: 34.7 Kg
---------------------	------------------

SPX-24

DRILL HEAD

Power Supply	: 230V 50/60Hz
Rated Current	: 15.8 A
Rated Output	: 2,400 W
Max. Output	: 6,400W
No-Load Speed	

HI	: 200 RPM
LOW	: 100 RPM

Size W x L x H	: 187 x 225 x 492mm
Weight	: 19.8 Kg

POLE BASE

Stroke	: 592mm
Size	: 200 x 320mm
Height	: 1050mm
Weight	: 19.0 Kg

CARRIAGE ASSEMBLY

Weight	: 7.8 Kg
Spacer Thickness	: 52mm
Total Weight	: 46.6 Kg

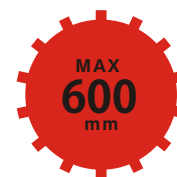

EHAC-80



AUTOMATIC FEEDING SYSTEM

Power Supply	:	230V 50/60Hz
Max Power Consumption	:	52.8W
Max. Feeding Speed	CL-49 Series	: 105mm/min.
	CL-59 Series	: 77mm/min.
Core Drill	:	SPF,SPN,SPZ,SPM,SPO
Core Bit Size When Reinforced Sensor Mode Is Applied	:	25 ~ 77mm (3")
Size	:	195 x 166 x 275mm
Weight	:	6.1 Kg

- ☐ The Automatic Feeding System used for an electric core drill, satisfy professionals.
- ☐ This is Automatic Feeding System of simple and compact type with just function most commonly used.
- ☐ Reinforcement sensor embedded system :- Machine equipped with function to discover necessary reinforcement concrete by aseismic (earthquake-proof) reinforcement construction.
- ☐ 13 steps of drill load setting.
- ☐ Auto stop setting can be changed.

VACUUM PUMP/PAD

Model	:	VPM-50V
Power Supply	:	230V 50/60Hz
Motor Output	:	40W
Pumping Speed	:	12/15 ℓ/min
Degree of Vacuum	:	0.094MPa
Size	:	220 x 340 x 230mm
Weight	:	12.0 Kg

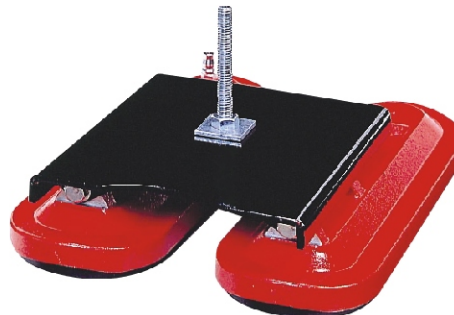
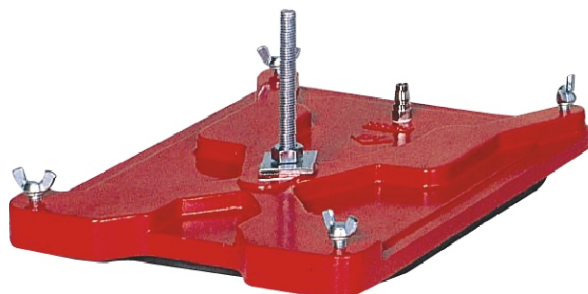

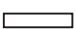
MODEL	:	VP-700W
TYPE	:	
APPLICATION	:	FLAT SURFACE
WEIGHT	:	5.3 KG

MODEL	:	VPH-20W
TYPE	:	
APPLICATION	:	OUTSIDE ROUND & FLAT SURFACE
WEIGHT	:	7.5 KG

PC-16

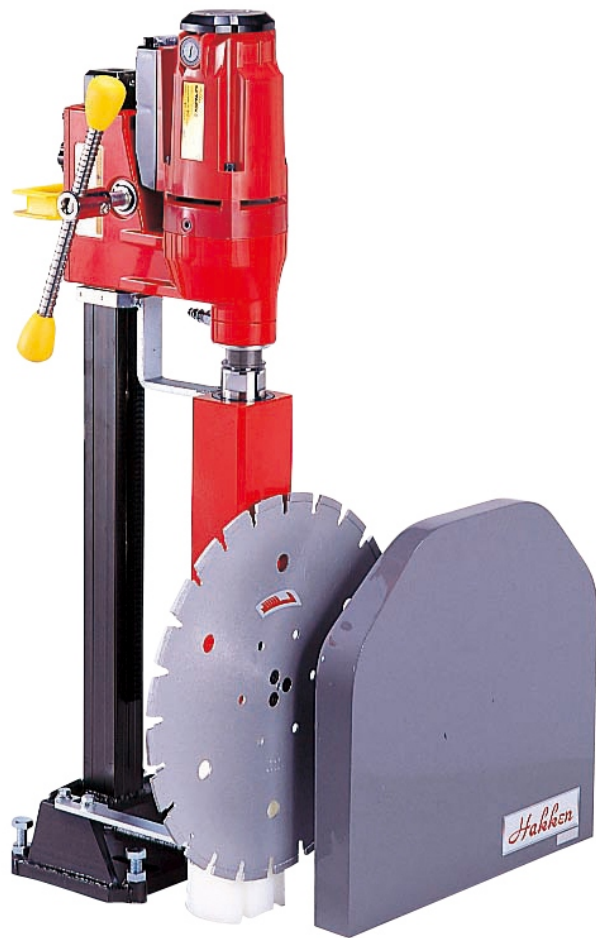

PLUNGE CUT ATTACHMENT

Unlike wall cutting which does not allow cutting deeper than the radius of diamond blade, plunge cutting enables cutting of thick **reinforced concrete** deeper than the diameter of blade for use by plunging its rotation axis into pilot hole, offering low noise, vibration free operation, PAT.

- ❑ The use combining with wall cutter enables to cut an opening section without overcutting.
- ❑ Can be open 350 ~ 450 quadrilateral hole only one anchor bolt works.
- ❑ The Plunge Cut Attachment is made up of three units, Main Body, Cover and Pole Base.
- ❑ Diamond Blade, Drill head and 4"BTC are required for execution.

Drill Head to be used : SPN-201
 Max. Thickness of Cut : 282mm
 Max. Blade Dia : 16"

BLADE SIZES

8" : 218 mm
 10" : 268 mm
 12" : 318 mm
 14" : 368 mm
 16" : 418 mm



ANCHOR BASE

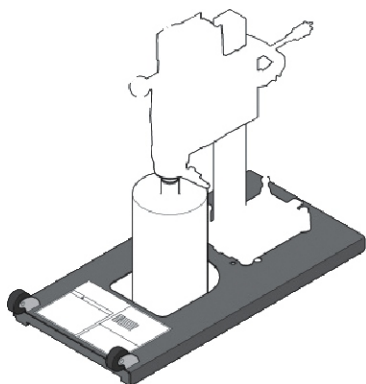

This use on asphalt road for the test piece collection

SUPPORT JACK

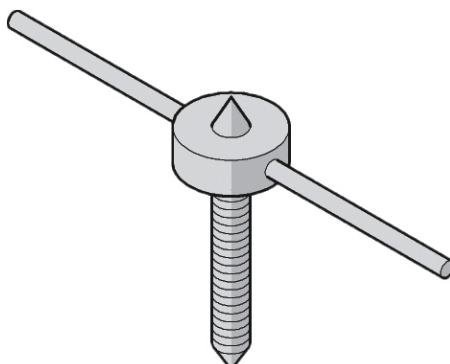

This use to fix in the M16 screw at top on the pole base without anchor bolts

WATER SUPPLY TANK



Water can be feed at even high places by air pressure.
 Tank capacity is 13ℓ

CDW-40

ELECTRIC WALL CUTTER



Model	CDW-40				
Power Supply	: 230V 50/60Hz				
Rated Output	: 2,400W				
Max. Output	: 6,400W				
No Load Speed	<table> <tr> <td>HI</td><td>: 840 RPM</td></tr> <tr> <td>LOW</td><td>: 340 RPM</td></tr> </table>	HI	: 840 RPM	LOW	: 340 RPM
HI	: 840 RPM				
LOW	: 340 RPM				
Standard Blade Dia.	: 30" (762mm)				
Max. Blade Dia.	: 40" (1,016mm)				
Blade Hole Dia.	: 35mm				
Max. Depth of Cut-	<table> <tr> <td>30"(762mm)</td><td>: 301mm</td></tr> <tr> <td>40"(1016mm)</td><td>: 428mm</td></tr> </table>	30"(762mm)	: 301mm	40"(1016mm)	: 428mm
30"(762mm)	: 301mm				
40"(1016mm)	: 428mm				
Size W x L x H	: 484 x 460 x 753mm				
Weight	: 36.5 Kg				

BLADE COVER

Model	30A	40A	48A
Blade Dia	30"	40"	48"
Weight	9.7 Kg	13.5 Kg	18.0 Kg.

TRACK RAIL

Model	600L	1200L	1800L
Length	600mm	1200mm	1800mm
Weight	6.3 Kg	12.5 Kg	18.8 Kg

DIAMOND BLADE

Model	Hole Dia.
CDW-40	35
CDW-30	35



CONTROL BOX

Model	BE-31
Power in Use	: 230V 50/60Hz
Max. Power Consumption	: 150W
Rated Current Control Range	: 30A
Size W x L x H	: 265 x 200 x 179mm
Weight	: 5.0 Kg

- ☐ Soft starting circuit is included
- ☐ Manual control is also possible
- ☐ Cutting load current is shown by bar chart Meter

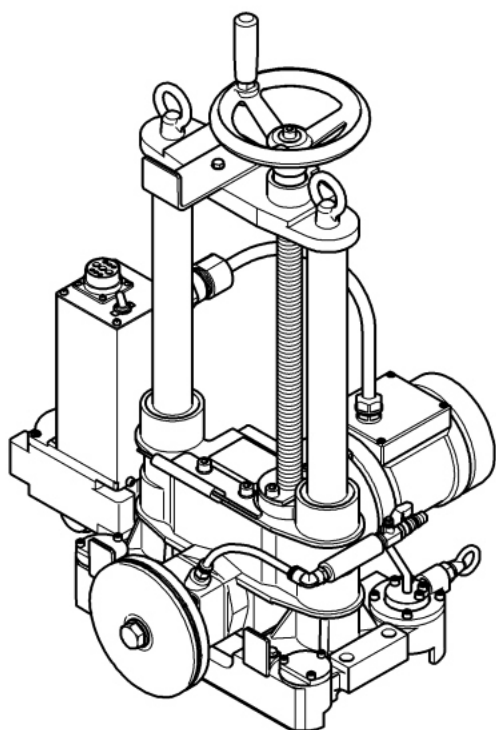



DSM-10

HYDRAULIC WIRE SAW

Model	DSM-10
Pressure	: 21MPa
Speed (Allowance)	: 850 RPM
Wire Dia.	: 10mm
Horizontal Stroke	: 1,197mm
Size W x L x H	: 1,370 x 557 x 1,831~2,054mm
Weight	: 150 Kg



HYDRAULIC UNIT

Power	: 20kw
	: Water-Cooled Motor
Size W x L x H	: 680 x 943 x 902~1,242mm
	: 680 x 792 x 824mm
Weight	: 200 Kg

ELECTRIC WIRE SAW

Model	DSX-10
Power Supply	: 230V 50/60Hz
Rated Output	: 2,400W
Max. Output	: 6,400W
No Load Speed	HI : 1000 RPM
	LOW : 420 RPM
Cutting Area Rectangle	: 0.62m ²
Cutting Area Column	: 0.65m ² (ø910)
Size W x L x H	: 919 x 532 x 1,486 mm
Weight	: 79.2 Kg

There is not trouble with an oil pressure unit and is most suitable wire saw for a small section around 0.6m² at a sharp turn.

DSX-10



CONTROL BOX



Model	BE-31
Power in Use	: 230V 50/60Hz
Max. Power Consumption	: 150W
Rated Current Control Range	: 30A
Size W x L x H	: 265 x 200 x 179mm
Weight	: 5.0 Kg

- ☐ Auto-Stop function can be used
- ☐ Soft starting circuit is included
- ☐ Manual control is also possible
- ☐ Cutting load current is shown by bar chart meter



KAKÚN

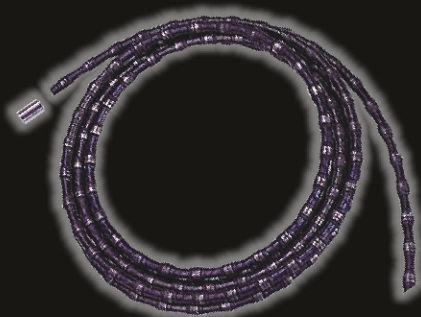
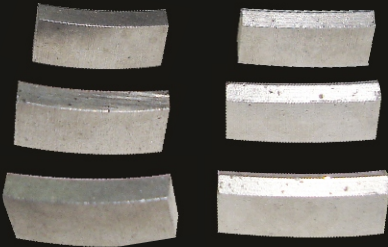

Imported, Marketed & Supported By :

vickytools

71/2A, Ground Floor, Rama Road Industrial Area, Moti Nagar, New Delhi-110 015, INDIA

Contact : +91-11-25910177, +91 9810679898, 8750001222

E-mail : vickytools@yahoo.com Website : www.vickytools.com